



SC-2K-UTV-MCBPK

SC-2K-UTV-X MOTORCYCLE

M-CHOCK & BASE PLATE KIT

1,000 lbs. Capacity (454 Kg)



ASSEMBLY & OPERATION MANUAL

NOTE!

(Supplement to the SC-2K-UTV-X Lift Installation & Operation Manual)

IMPORTANT!!

READ MANUAL THOROUGHLY BEFORE ASSEMBLING OR USING TO PREVENT INJURY OR DAMAGES. WHEN COMPLETED WITH ASSEMBLY, ENSURE TO RETURN MANUAL & RELATED DOCUMENTS IN PROTECTIVE SLEEVE FOR FUTURE REFERENCE.

SC-2K-UTV-MCBPK
JUL 2024

1. Safety & Cautions

Important Statements:

Please note the max weight capacity noted on the yellow CAUTION decal on the SC-2K-UTV-MCBPK M-Chock Base Plate and overall lift capacity on the silver ID Tag attached to the SC-2K-UTV-X lift's main post. Do not try to lift any load that exceeds the rated lifting capacity, including each platform. Please read this manual carefully before assembly and use of the lift, to avoid any property loss or personal injury caused by faulty operation. No one is allowed to modify the controls, parts, or other mechanical parts of the machine without the manufacturer's permission.

Qualification of Operators and Users:

- Only personnel who have read the manual and received training are allowed to operate and use the SC-2K-UTV-X Lift and SC-2K-UTV-MCBPK M-CHOCK Base Plate Kit.
- Only qualified, experienced, and licensed motorcyclist are allowed to operate and use the SC-2K-UTV-X Lift and SC-2K-UTV-MCBPK M-CHOCK Base Plate Kit.
- Non-qualified professionals or personnel shall not approach the loading and lifting area.

Cautions:

- Please read and understand Safety Cautions carefully before operation of the M-Chock Base Plate Kit and Lift.
- The lift shall not be used outdoors if not customized to meet special water proofing requirements.
- Hands and feet shall be kept away from moving parts of the lift at all times.
- Only personnel who have received professional training are allowed to operate and use the lift.
- Operators should not wear loose clothes to avoid being clamped by any moving part when the machine is descending or rising.
- Area around the lift must be kept clean to help avoid accidents and possible lift malfunctions.
- The lift is designed to lift the entire vehicle, not part of it. Do not try to lift any vehicle beyond the lift's rated lifting capacity.
- Make sure the lift is secured on the safety locks before working on a lifted vehicle.
- Always lift vehicle / motorcycle slightly, checking the vehicle is stable without any risk of tipping or falling, before lifting it to the desired height.
- Check for any missing, broken, or seized parts or components that may contribute to improper wear & tear. Once any anomaly is detected, stop use immediately and contact your dealer.
- Always fully lower lift to the lowest position before driving a vehicle On or Off the lift platforms.
- It is not allowed to modify any part of the lift without the manufacturer's permission.
- If the machine is to stand idle for a long period of time, the operator / user shall:
 - a. Turn off electrical power.
 - b. Drain hydraulic oil from power unit. (Per local codes, dispose of used oil responsibly.)
 - c. Lubricate moving parts with grease.

SC-2K-UTV-MCBPK CAUTION Decal

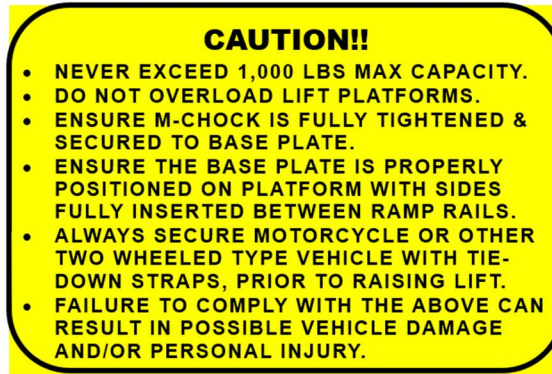

Training:

- Lift operators must be qualified & trained for safe use and proper operation, as described in Manual.

Owner / Employer Responsibilities: (Also reference SC-2K-UTV-X Manual)

Proper application of the equipment described herein is limited to the parameters detailed in the specifications and the usages set forth in the descriptive passages. Any other proposed application of this equipment should be documented and submitted in writing to the factory for examination. The user assumes full responsibility for any equipment damage, personal injury, or alteration of the equipment described in this manual or any subsequent damages.

2. Product Information

M-Chock / Base Plate Kit Description: (SC-2K-UTV-MCBPK)

The iDEAL M-Chock & Base Plate Kit (SC-2K-UTV-MCBPK) is an exclusive designed optional accessory Kit for the iDEAL SC-2K-UTV-X Lift, providing the ability for safe storage or service for most motorcycles up to 1,000 lbs. utilizing the SC-2K-UTV-X Lifts multi-adjustable platform design with multi-directional front & side motorcycle loading. The M-Chock's adjustable self-locking pivot cradle design allows for easy one-person loading & unloading, while the Base Plate provides two different mounting configurations for front or side platform loading options at multiple platform locations. The M-Chock & Base Plate comes standard with durable powder-coat paint finish, heavy-duty steel construction while including two Tie-Down Ring Eyelets assisting in securing motorcycle to platforms. Add another M-Chock & Base Plate Kit to the SC-2K-UTV-X Lift, if space allows and not exceeding the weight capacity of platforms.

Specifications:

MC Accessory Model	SC-2K-UTV-MCBPK
Max Capacity	1,000 lbs.
MC Base Plate L x W	20.7+x 18.2+
Height Overall (w/ M-Chock)	12.7+
Max Front Wheel Width	6.5+
Wheel Sizes	16+to 19+
MCBPK Weight	38 lbs.
Ship Weight	48 lbs.

Required Tools:

- Metric Socket Set & Ratchet
- Metric Hex Key Wrench Set
- Adjustable Wrench
- Safety Glasses
- Gloves

Selecting Site:

NOTE: Before assembling & applying your new (SC-2K-UTV-MCBPK) M-Chock / Base Plate Kit to the SC-2K-UTV-X lift, ensure to check the following:

Overhead Obstructions:

The area where the M-Chock / Base Plate Kit will be positioned & loaded on the lift platforms should be free of any overhead obstructions such as heaters, building supports, electrical lines, etc. whenever fully raising motorcycle(s) or other related vehicles. **Failure to comply could result in Property, Vehicle & Lift damages.**

M-Chock / Base Plate Kit Key Features: (SC-2K-UTV-MCBPK)

- ❖ M-Chock & Base Plate Kit (SC-2K-UTV-MCBPK) is exclusively designed as an optional accessory for the iDEAL SC-2K-UTV-X Single Column UTV & Mower Storage / Service Lift,
- ❖ The M-Chock & Base Plate Kit (SC-2K-UTV-MCBPK) allows the ability to safely store & service most motorcycles at multiple locking heights.
- ❖ The M-Chock is designed to mount to the Base Plate in two different mounting configurations, allowing for multiple loading positions for front or side platform loading options.
- ❖ M-Chock includes 12 adjustable pivot cradle positions for optimal self-locking operation for front motorcycle tires up to 6.5+ wide.
- ❖ M-Chock fits most front motorcycle wheel diameter sizes ranging from 16+ to 19+.
- ❖ Kit includes Narrow Tire Adaptors for tires 3.5+ or narrower.
- ❖ Allows for one-person load & unload operation.
- ❖ 2ea Tie-Down Ring Eyelets included in Kit assisting in securing motorcycle to lift platform(s).
- ❖ Heavy-Duty steel construction with durable powder-coat paint finish.

3. Assembly Instructions

WARNING!! Improper assembly & installation can cause accelerated wear, resulting in catastrophic failure which may cause property damage and / or bodily injury. Manufacturer will assume no liability for loss or damage of any kind, expressed or implied, resulting from improper installation or use of this product. Read this installation manual in its entirety before attempting to install or operate the lift.

Assembly Steps:

- 1) Carefully remove **M-Chock Frame, Pivot Cradle, Base Plate, Shims Plates, Ring Eyelets & Hardware Bag** from box package.
- 2) Connect the **Pivot Cradle** to **M-Chock Frame** with **2ea M10 x 25mm pivot bolts** and **2ea M10 nylon lock nuts**. Fig. 1. (**NOTE:** See Page 8 for M-Chock's Pivot Cradle Wheel Adjustment information)

NOTE: Ensure Pivot Cradle is able to pivot freely after securing to the M-Chock Frame.

(If Applicable) Apply **Narrow Tire Adaptor Pads** to inside of **Pivot Cradle** for Front Tire widths of 3.5+ or narrower. Install **Pads to Pivot Cradle** using **4ea M8 x 10mm Screws & M8 Nylon Lock Nuts**. Fig.1.

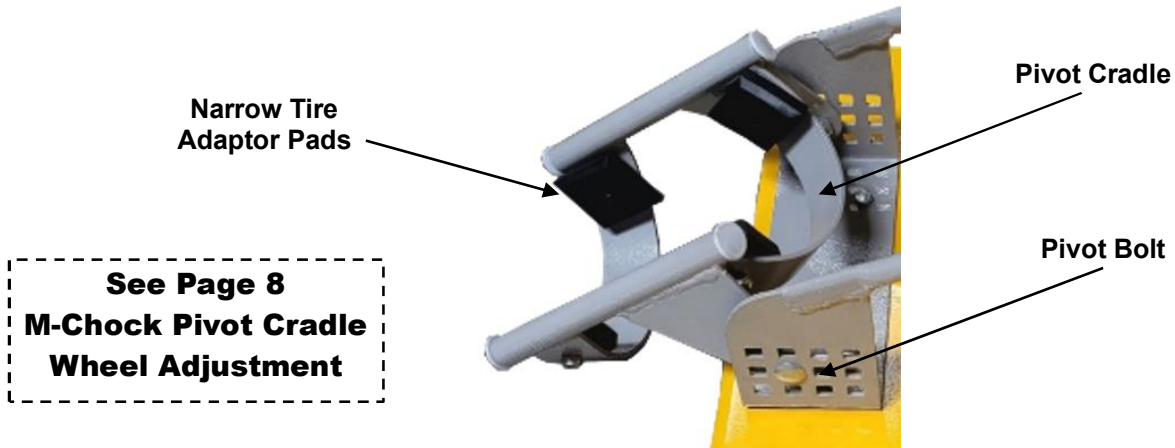

Fig. 1.

3) Align the **M-Chock Frame** holes to **Base Plate** holes for either 'Front or Side' loading configurations. Fig. 2.

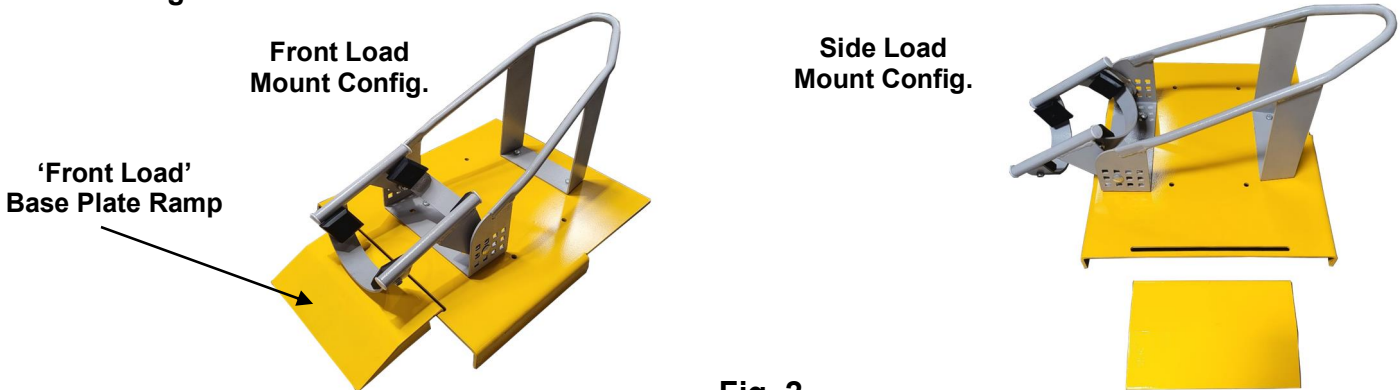

Fig. 2.

4) Once the loading configuration is determined, attach **M-Chock Frame** to **Base Plate** using **4ea M8 x 20mm Hex Bolts, 4ea D8 Flat Washers & 4ea D8 Nylon Lock Nuts**.

SPECIAL NOTE: Must Use the 'forward' Positioned Rear Mount Holes to mount M-Chock to Base Plate for either 'Front or Side' mounting configurations. Fig. 3.

5) Check that all mounting hardware is properly tightened, ensuring the **M-Chock** is firmly connected to the **Base Plate** and in the **correct mounting holes**.

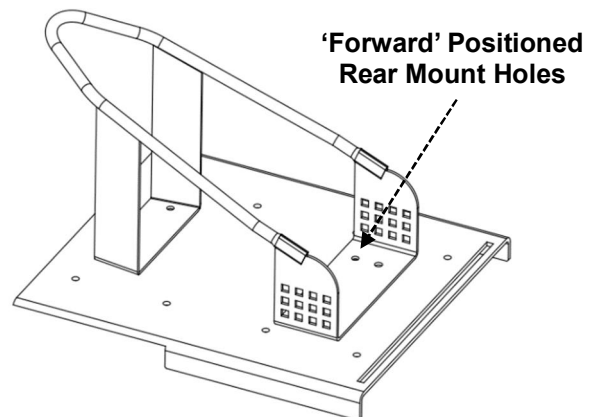

Fig. 3.

4. Operation Instructions

‘FRONT OR SIDE’ POSITIONING & LOADING DIRECTION:

- ❖ Determine which loading direction the motorcycle will be: **Front or Side Loading**. Figs. 4 & 5.
- ❖ For **Front Loading**, select which Platform (**LH or RH**) will be the best to **position** the motorcycle for shop or garage storage or service. Fig. 4.

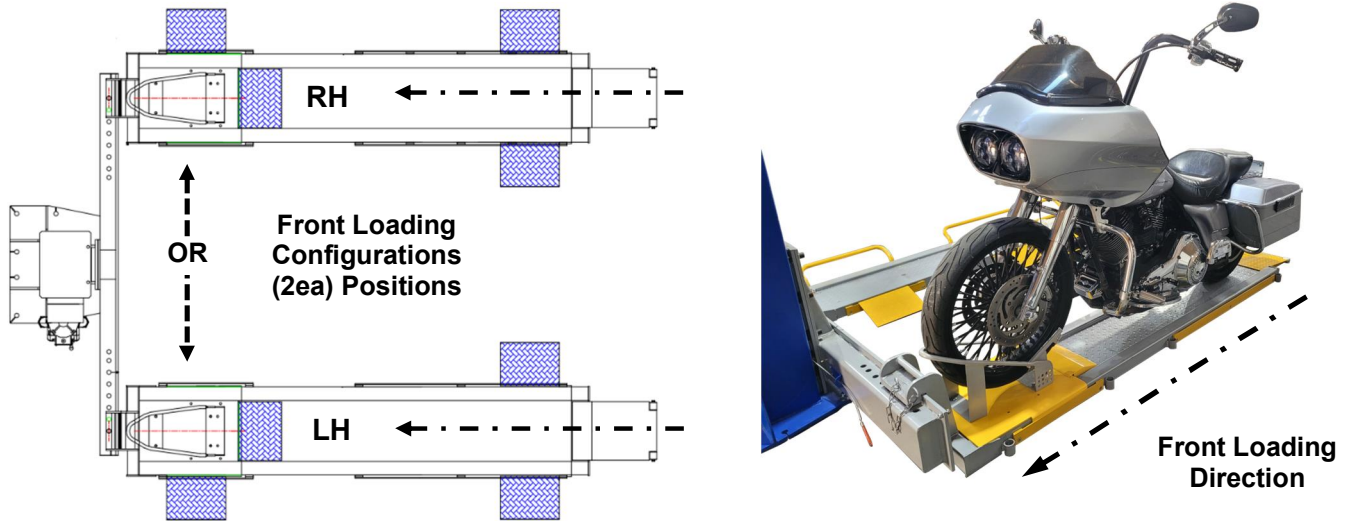
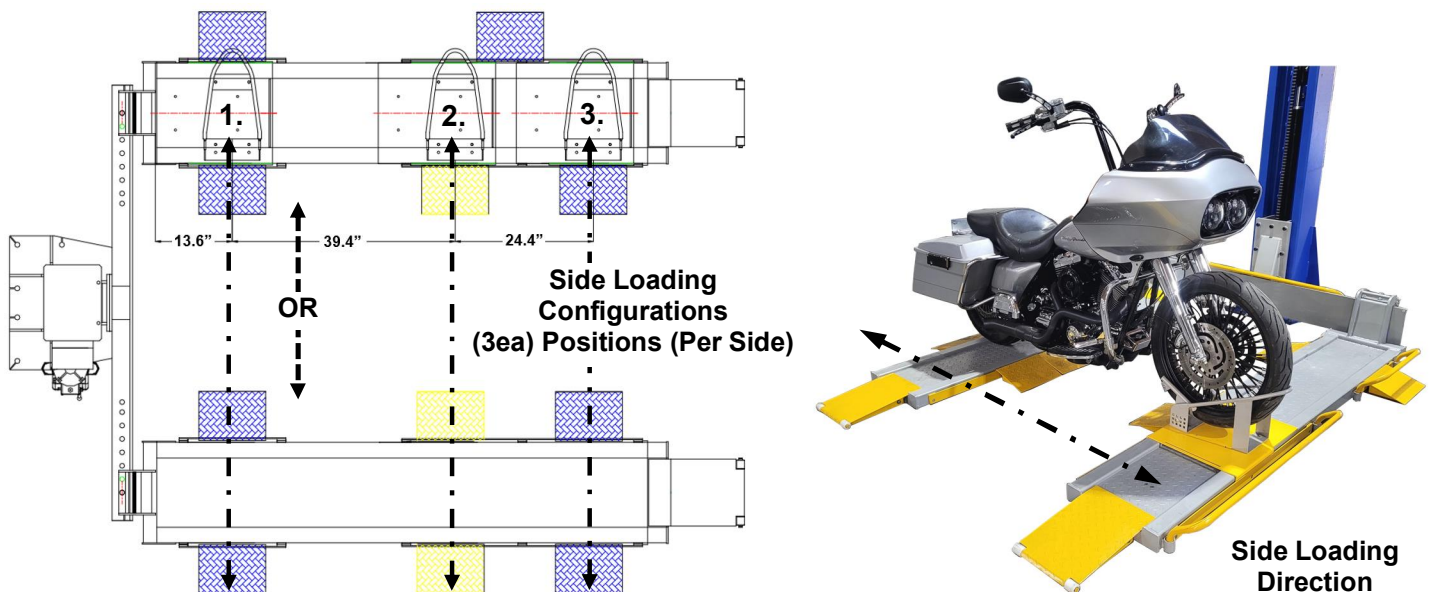

Fig. 4.

- Once determined, position M-Chock Base Plate assembly to the desired platform, insert it to the front platform section, making sure the Base Plate sides are fully inserted & secured between the platform & side ramp brackets. Insert small ramp to back of Base Plate. Figs. 2 & 7.
- ❖ For **Side Loading**, determine the Platform (**approach side & position**) of M-Chock Base Plate.
 - Adjust Platform widths to match center of motorcycle wheels. Remove wheel stop bars on load side, while adjusting side ramps to the wheel path, prior to loading onto platforms. Fig. 5.



*Apply Heavier Loads to #1 or #2 Positions.

Fig. 5.

CAUTION: Always Position Heavy Motorcycles to either the #1 or #2 Positions for Side Loading.

SPECIAL NOTE: When using the Side Load Configuration, 'Spacer Shims' must be installed to the 'inside' platform ramp support rails, allowing for enough 'gap clearance' for both Base Plate & Side Ramps to be installed together.

- Install spacer shims to inside Platform Ramp Rails, based on the selected Side Load Position of the M-Chock & Base Plate, OR install ALL Spacer Shims to inside rails for ALL 3ea possible Side Load position options. **Figs. 5 & 6.**
- Beginning at one end at a time, use Hex Key to loosen & remove the Countersunk Screws supporting the inside platform ramps rails. Apply ~~large~~Spacer Shims to ramp rails ~~at~~ outside ends, applying the ~~small~~Spacer Shim to the center-section of ramp rail. **Fig. 6.**
- Position & align Spacer Shim between platform & ramp rail, then secure with Countersunk Screw, leaving slightly loose until all Spacer Shims are installed. Once all Spacer Shims are installed, tighten all screws to secure inside ramps rails back to platform. **Fig. 6.**

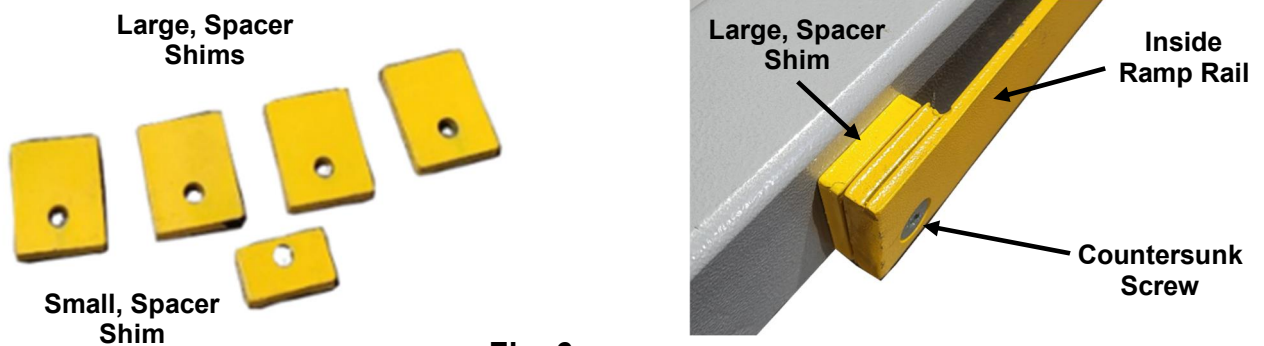
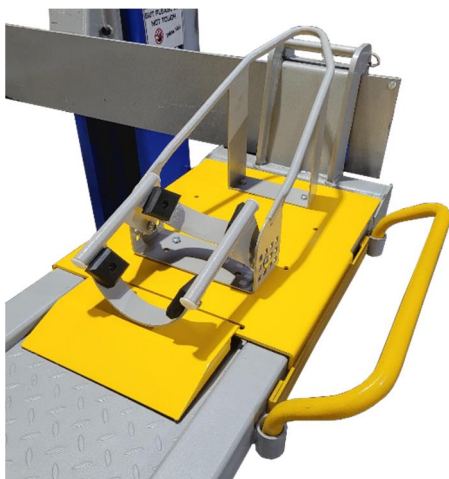

Fig. 6.

- Once inside ramp rail shims are installed, position the M-Chock Base Plate assembly to the desired platform side & position, making sure the Base Plate sides are fully inserted & secured between the platform, side ramp & side ramp brackets. **Fig. 8**
- Remove wheel stop bars prior to loading motorcycle onto platform(s). After loading, ensure the motorcycle's rear wheel is aligned to the center of the platform.



'Front Load' Position (RH)



'Side Load' Position (#1 LH)

Figs. 7 & 8.

PIVOT CRADLE ADJUSTMENT:

- ❖ Using the Pictures & Diagram below, adjust M-Chock Pivot Cradle to one of 12ea positions to best fit & secure the motorcycle's front tire, allowing the motorcycle to be in a stable upright position.

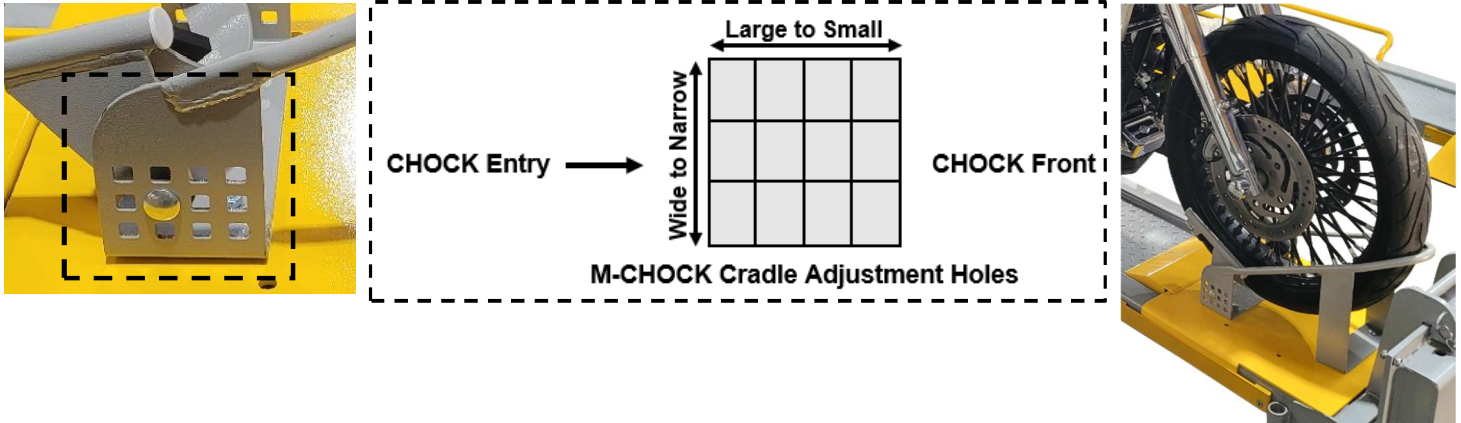

MOTORCYCLE LOADING / OFF-LOADING:

Loading:

1. Ensure M-Chock Base Plate are properly positioned & secured to platform and platforms are fully lowered.
2. Remove platform wheel stop bars and align side ramps (if required) prior to loading motorcycle onto platform(s).
3. Carefully push or ride motorcycle on the fully lowered lift platform(s) while keeping the motorcycle centered and balanced.
4. Slowly push or drive forward until the front wheel fully engages into M-Chock.

IMPORTANT: Check for upright stability before letting motorcycle self-stand. If motorcycle is not stable enough to self-stand, remove and readjust pivot cradle, while also adding narrow tire pads.

5. After loading, ensure the motorcycle's rear wheel is aligned to the center of the platform.
6. Secure motorcycle using provided Ring Eyelets to multiple tie-down anchor points on lift.

Off-Loading:

1. Ensure lift platforms are fully lowered before removing motorcycle from M-Chock and off platform(s).
2. Remove tie-downs, securing motorcycle to lift platform(s).
3. Release motorcycle from M-Chock by pulling backwards on motorcycle.

NOTE: In some cases a second person may be required to assist by pushing & rotating back the top of the front tire to remove from M-Chock.

CAUTION: Be prepared to use brakes to control motorcycle movement once front wheel is released from M-Chock.

4. Carefully, back the motorcycle off the lift platforms, maintaining proper balance.

TIE-DOWN ANCHOR POINTS DIAGRAM:

WARNING: Always use Tie-Down Anchor Points & Tie-Down Straps to secure Motorcycle to Lift, prior to raising to store or service.

- ❖ Using the Diagram below, apply provided 2ea Ring Eyelets to one of the 10ea threaded Anchor points located on the SC-2K-UTV-X Lift to best secure motorcycle to the lifting platforms.

Ring Eyelets Tie-Down Locations (5ea Per Side)

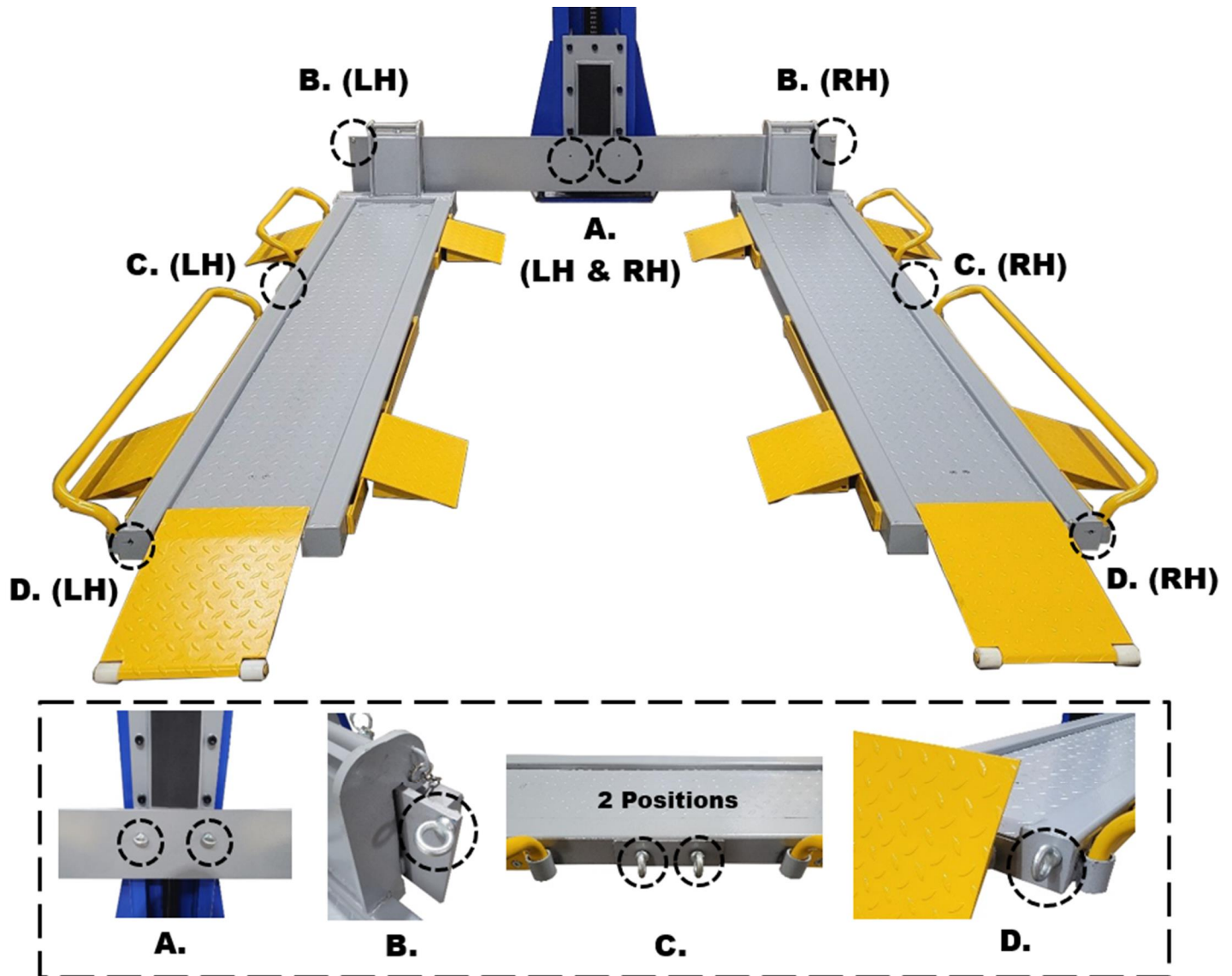

NOTE: The (SC-2K-UTV-MCBPK) M-Chock & Base Plate Kit Does Not Include Tie-Down Straps. Customer is responsible for providing Tie-Down Straps to secure motorcycle to SC-2K-UTV-X Lift.

5. Reference SC-2K-UTV-X Manual for following Information:

- **Raising & Lowering Lift**
- **Platform 'Angle' Adjustment Tips**
- **Troubleshooting:**
- **Preventive Maintenance**

CAUTION: Before driving a vehicle onto the lift, ensure the lift is fully lowered and platforms are properly adjusted to match vehicle wheels.

NOTE: Be careful when raising vehicle so not to make contact with ceiling or any other overhead obstructions that may damage vehicle or garage or building during lift operation.

CAUTION: Before removing vehicle from lift , ensure to remove wheel stop bars and adjust side ramps, if required.

Exploded View

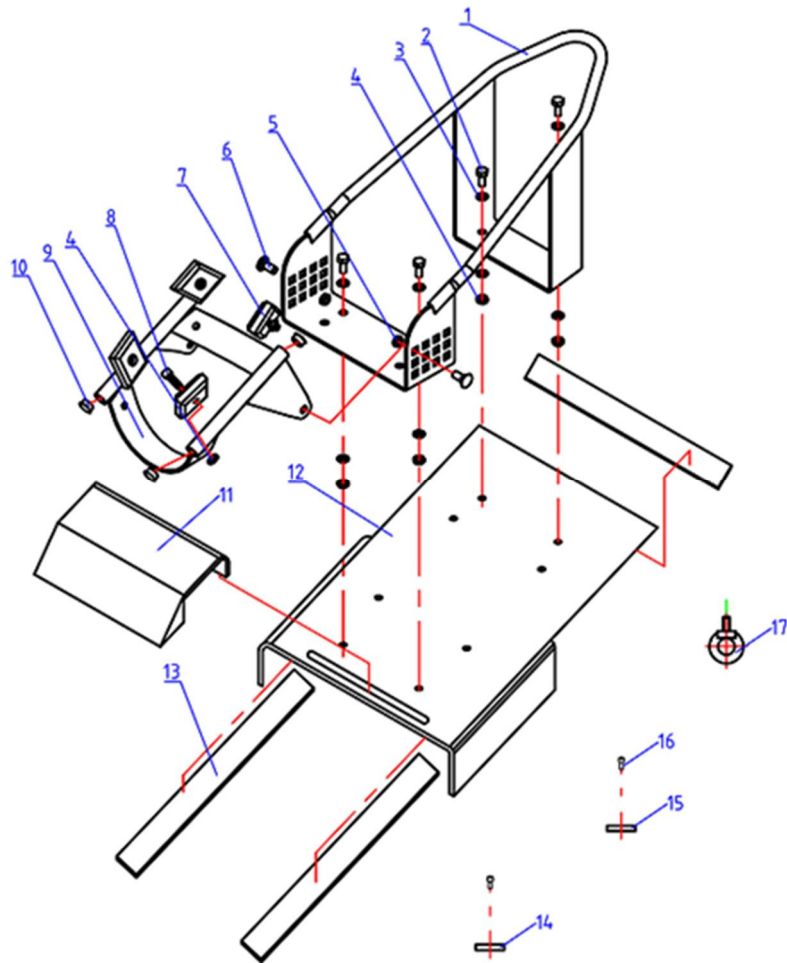

Parts List

ITEM	TUX P/N	M-REF P/N	DESCRIPTION	QTY.
1	SC-2K-UTV-MCBPK-001	JP23-12100-JT2	M-CHOCK (MCBPK)	1
2	SC-2K-UTV-MCBPK-002	5102-08020-000	Hex Bolt, M8 x 20mm	4
3	SC-2K-UTV-MCBPK-003	5302-00008-000	Flat Washer, D8	8
4	SC-2K-UTV-MCBPK-004	5206-00008-000	Nylon Lock Nut, M8	8
5	SC-2K-UTV-MCBPK-005	5206-00010-000	Nylon Lock Nut, M10	2
6	SC-2K-UTV-MCBPK-006	5124-10025-000	Pivot Bolt, M10 x 25mm	2
7	SC-2K-UTV-MCBPK-007	JP23-12001-JT2	Narrow Tire, Adaptor Pad	4
8	SC-2K-UTV-MCBPK-008	5105-08025-000	Screw, M8 x 10mm	4
9	SC-2K-UTV-MCBPK-009	JP23-12200-JT2	Pivot Cradle	1
10	SC-2K-UTV-MCBPK-010	JP23-12006-JT2	Cap	4
11	SC-2K-UTV-MCBPK-011	TC02-30004-FJ2	Base Plate Ramp	1
12	SC-2K-UTV-MCBPK-012	TC02-30101-FJ2	MC Base Plate	1
13	SC-2K-UTV-MCBPK-013	TC02-30102-FJ2	Rubber Strip	3
14	SC-2K-UTV-MCBPK-014	TC02-30002-FJ2	Small, Spacer Shim	1
15	SC-2K-UTV-MCBPK-015	TC02-30001-FJ2	Large, Spacer Shims	4
16	SC-2K-UTV-MCBPK-016	5701-08025-000	Tapered Bolt, M5 x 25mm	5
17	SC-2K-UTV-MCBPK-017	JP02-00009-000	Eye Bolt, M10	2

LIMITED WARRANTY

Structural Warranty:

The following parts and structural components carry a five-year warranty:

Columns	Arms	Uprights	Swivel Pins
Legs	Carriages	Overhead Beam	Platforms
Tracks	Cross Rails	Top Rail Beam	

Limited One-Year Warranty:

Tuxedo Distributors, LLC (iDEAL) offers a limited one-year warranty to the original purchaser of Lifts and Wheel Service equipment in the United States and Canada. Tuxedo will replace, without charge, any part found defective in materials or workmanship under normal use, for a period of one year after purchase. The purchaser is responsible for all shipping charges. This warranty does not apply to equipment that has been improperly installed or altered or that has not been operated or maintained according to specifications.

Other Limitations:

This warranty does not cover:

1. Parts needed for normal maintenance
2. Wear parts, including but not limited to cables, slider blocks, chains, rubber pads and pulleys
3. Replacement of lift and tire changer cylinders after the first 30 days. A seal kit and installation instructions will be sent for repairs thereafter.
4. On-site labor

Upon receipt, the customer must visually inspect the equipment for any potential freight damage before signing clear on the shipping receipt. Freight damage is not considered a warranty issue and therefore must be noted for any potential recovery with the shipping company.

The customer is required to notify Tuxedo of any missing parts within 72 hours. Timely notification must be received to be covered under warranty.

Tuxedo will replace any defective part under warranty at no charge as soon as such parts become available from the manufacturer. No guarantee is given as to the immediate availability of replacement parts.

Tuxedo reserves the right to make improvements and/or design changes to its lifts without any obligation to previously sold, assembled, or fabricated equipment.

There is no other express warranty on the Tuxedo lifts and this warranty is exclusive of and in lieu of all other warranties, expressed or implied, including all warranties of merchantability and fitness for a particular purpose.

To the fullest extent allowed by law, Tuxedo shall not be liable for loss of use, cost of cover, lost profits, inconvenience, lost time, commercial loss or other incidental or consequential damages.

This Limited Warranty is granted to the original purchaser only and is not transferable or assignable.

Some states do not allow exclusion or limitation of consequential damages or how long an implied warranty lasts, so the above limitations and exclusions may not apply. This warranty gives you specific legal rights and you may have other rights, which may vary from state to state.

8320 E Hwy 67, Alvarado, TX 76009
Ph. 817-558-9337 / Fax 817-558-9740